



Fitting a V8 Register grille badge to an RV8

John Anthistle says he hasn't fitted an MG Car Club badge to his RV8 and it sounds a bit different. He did however fit a V8 Register grille badge (see above) some time ago and decided this was most

easily done by removing the radiator duct from beneath the front bumper (two vertical 7/16 AF bolts). A socket and short extension makes the job easier. It is then just possible to get a hand up behind the mesh grille to secure the badge. He found the threaded pins on the back of the V8 Register badge over-long for his chosen location (towards the kerb side of the grille) so he shortened them appropriately. Other than that it was just a rather fiddly but manageable job.

Locating the duct for removal for hand access behind the grille mesh

John says "to get an idea of the part to which I am referring, have a look at the RV8 Repair Manual AKM7153ENG section 'Body Repairs' page 2 - the duct is there referred to as an '**under cowl**''. It is more clearly illustrated on the RV8 Parts Fiche, Section O 02 Item 18 where it is referred to as a '**duct**'".

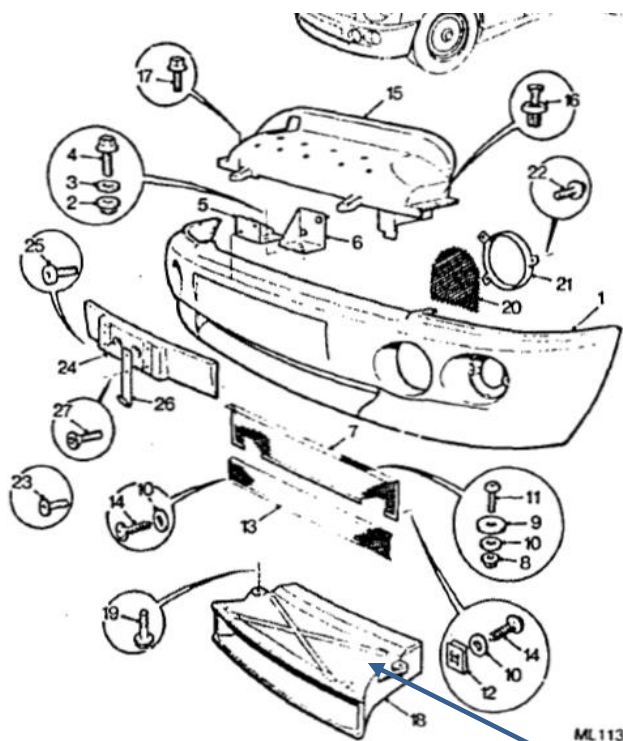

RV8 Parts Fiche, Section O 02, Item 18 is ZKC6634 Duct – lower radiator

John adds that despite what the Repair Manual says, you can remove the under cowl and gain access behind the grille mesh with the vehicle on the ground so avoiding the need to raise the car.

UNDER COWLING

Service Repair No. 76.10.50

Remove

1. Raise front of vehicle.

WARNING: Support on safety stands.

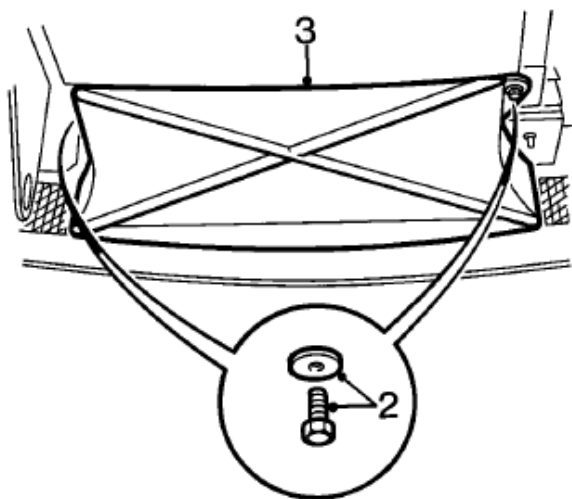

76M 0990

2. Remove 2 bolts with plain washers securing under cowl to body.
3. Remove under cowl.

RV8 Repair Manual AKM7153 section Body Repairs page 2