

Changing the fuel filter is necessary even on a low mileage RV8

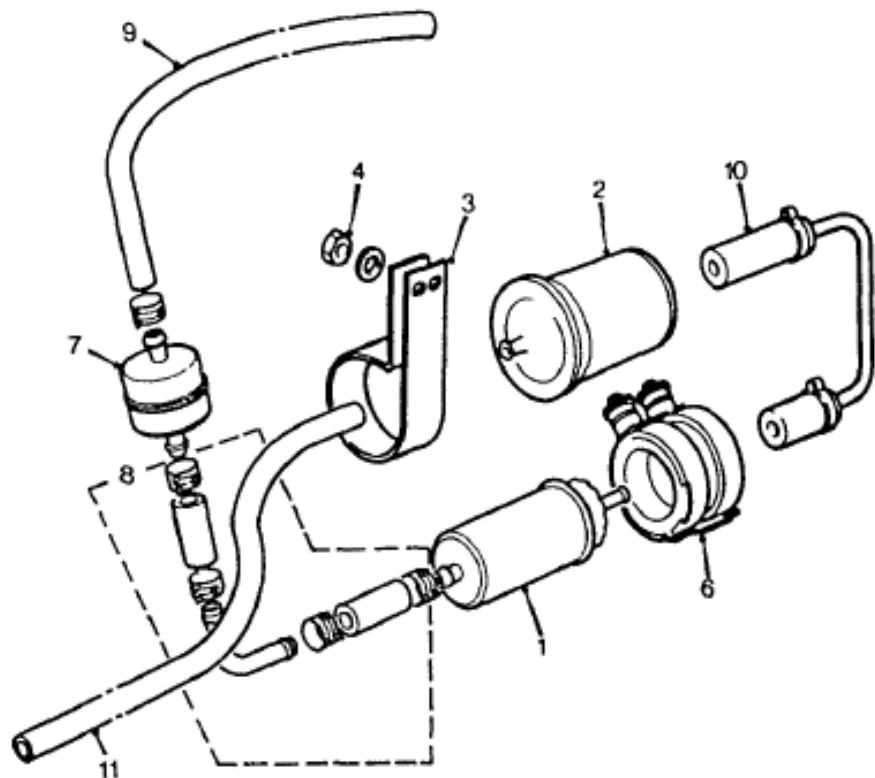

Illus	Part Number	123456	Description	Quantity
FUEL PUMP, FILTER AND FITTINGS				
1	AUU 1649		Pump-fuel	1
2	GFE 7001		Filter-fuel	1
3	ZKC 5022		Bracket-filter	1
4	FN 106041		Nut-bracket to body	1
5			Clip	3
6	ZKC 5008		Mounting-fuel pump	1
7	GFE 7004		Filter-fuel	1
8	ZKC 5060		Elbow assembly-pump to filter	1
9	ZKC 5070		Hose-filter to feed pipe-170mm	1
10	ZKC 5029		Pipe-filter to pump	1
11	ZKC 5032		Hose-filter to feed line	1

Sheet J09 – RV8 Parts Manual – Item 2 GFE7001 Filter-fuel



Jeff Shaw successfully bid for the very low mileage RV8 in Le Mans Green at the H&H auction at Duxford in March 2020 and says the clutch packed up there so the car could not be driven from Duxford and was brought home on a truck. Jeff says it needs a thorough recommission and a number of small dings on the bodywork repaired. The widow who sold the car had it stored for many years. As Jeff works his way through the maintenance items he has a report which acts as a reminder for fellow RV8 owners of the **need to change their fuel filters regularly**. Above is the filter he removed from the RV8 with only 4,600 miles on the clock – clearly the filter is in a grim state! Jeff says “just because it is a low mileage car don’t think that the filter does not need changing”. He thinks he may have to drop the tank and flush it through.